

## SYIC-83300

## 光電式尋邊器

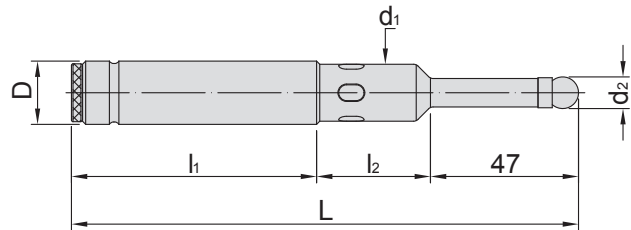
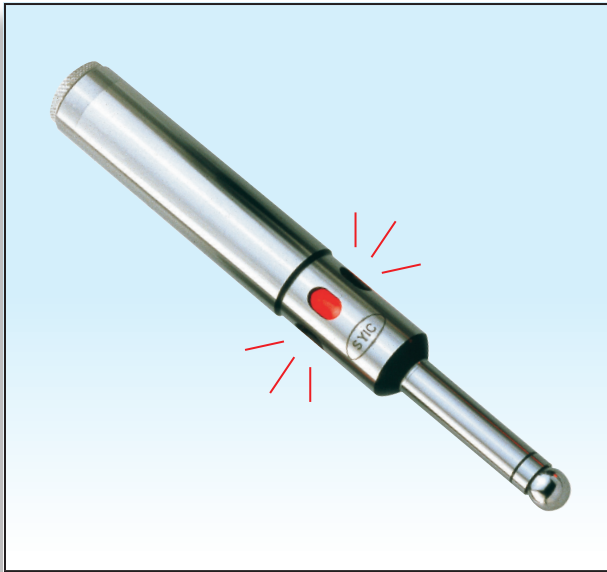

- Quickly locate working edges.
- Save time to find positions, for Milling Machine, Jig borers, and other machine tools.

### IS A HIGH SENSIBLE POSITION MEASURING

- Uses dry batteries to light the red lamp.
- The scope of application includes edge surface, inside and outside diameters and high efficiency.
- There is a safety spring puller, which will put a ball precisely back to the position when ball breaks away from ball seat.

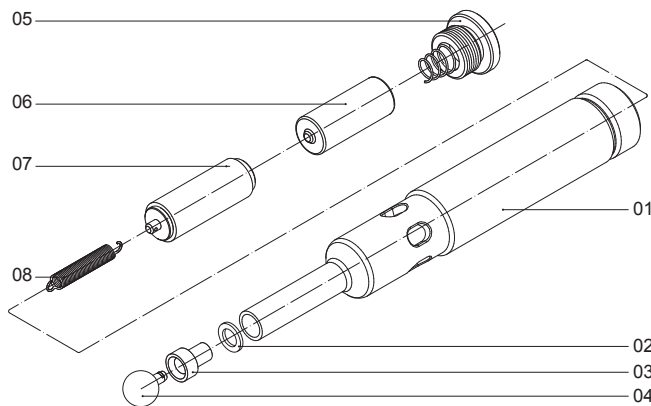
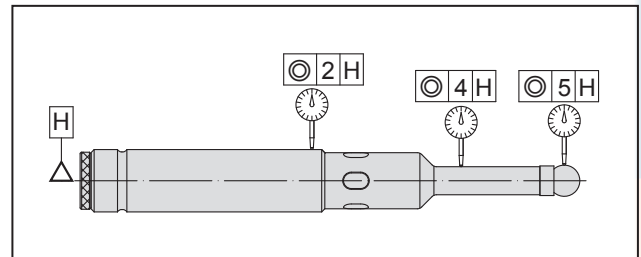

MODEL NO.	NO.	NAME OF EACH PART
SYIC - 83300 - 1	1	Shank
SYIC - 83300 - 2	2	Insulate flake
SYIC - 83300 - 3	3	Steel ball seat
SYIC - 83300 - 4	4	Steel ball
SYIC - 83300 - 5	5	Batteries cap
SYIC - 83300 - 6	6	Batteries
SYIC - 83300 - 7	7	LED bulb
SYIC - 83300 - 8	8	Spring

MODEL NO.	TYPE	D	d <sub>1</sub>	d <sub>2</sub>	L	l <sub>1</sub>	l <sub>2</sub>	BATTERY TYPE	WEIGHT (KGS)
SYIC - 83301	OP - 20	20	18	10	160	79	34	UM - 5(SP) 2P/R1/1.5V	0.3
SYIC - 83302	OP - 32	32							0.6

## SYIC-83310

## 警示鳴音 光電尋邊器

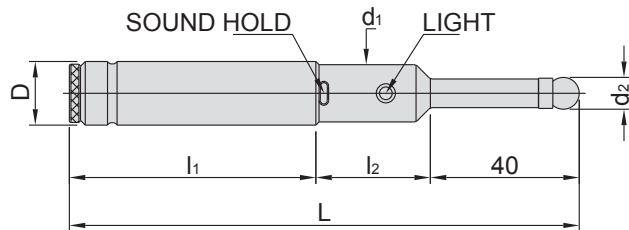
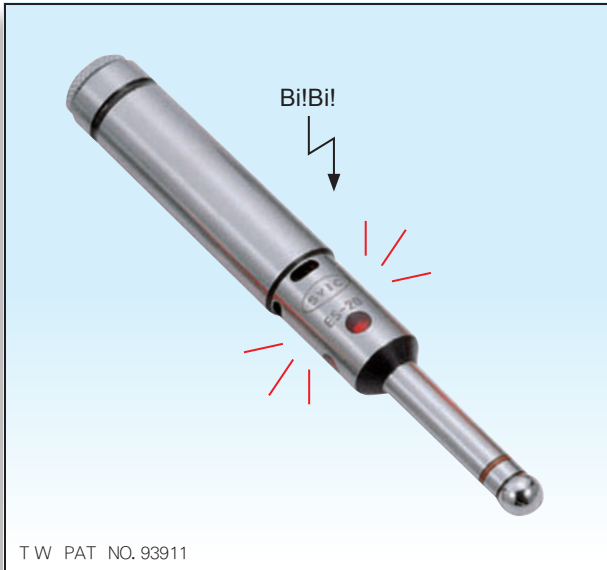

- The red lamp can concentrate light and resist water.
- It will beep at the same time when the red lamp is on.
- When probe is in a deep hole you can't see the red light, but you can hear the sound.

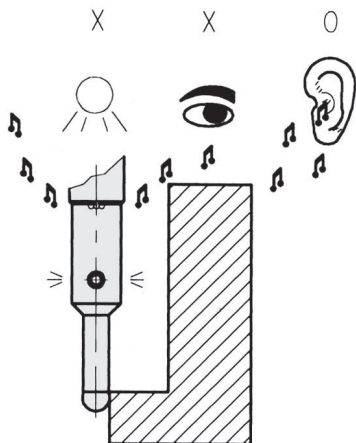

How to use the Optical Edge Finder:

1. Mount the Edge Finder into tool holder and check if its concentricity is within 0.005mm.
2. Move the work table to make the edge of work piece touch the ball of Edge Finder until the red lamp is on.
3. Mark the reading dial of table movement, backward the table a little and re-touch the work piece to Edge Finder slightly until the red lamp is on again to make sure of the correct dial reading.
4. Zero the reading dial and move the table to the desired position by adding 5mm to the desired dimension X.
5. Take off the Edge Finder and remount the desired tooling for machining.

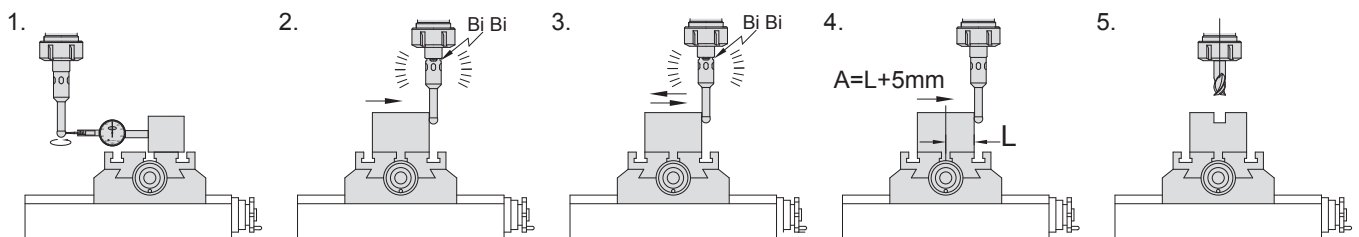

MODEL NO.	TYPE	D	d <sub>1</sub>	d <sub>2</sub>	L	l <sub>1</sub>	l <sub>2</sub>	BATTERY TYPE	WEIGHT (KGS)
SYIC - 83311	ES - 20	20	18	10	160	79	41	UM5# x 2pcs	0.35
SYIC - 83312	ES - 32	32							0.60

## SYIC-83350

## 偏心式尋邊器

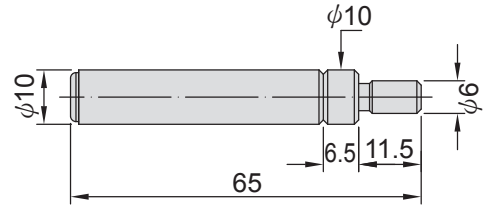
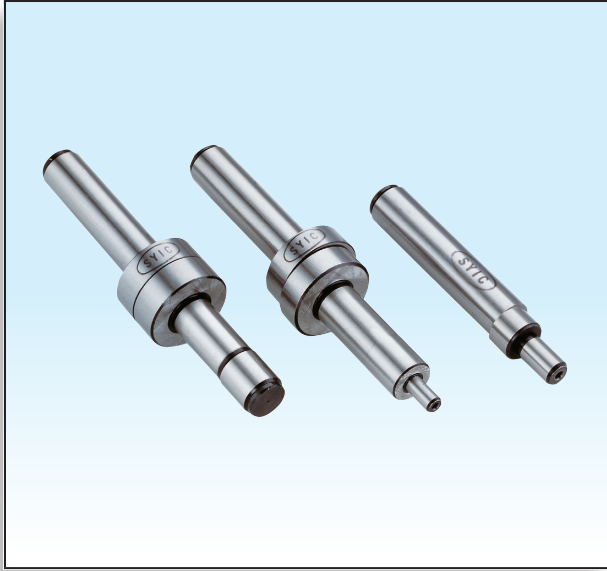

ER 610

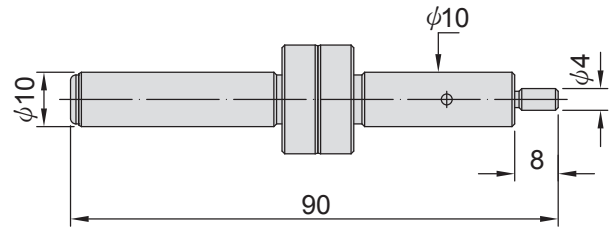

ER 420

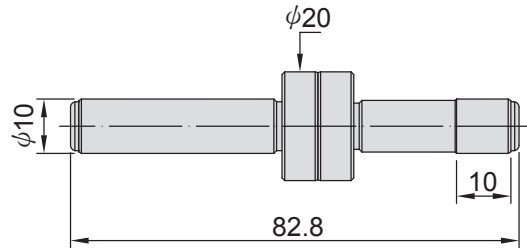

ER 1020

- Steel: SCM - 21
- HRC: 56°
- SYIC - 83352 TYPE ME610
- SYIC - 83354 TYPE ME420
- SYIC - 83356 TYPE ME1020

**Hard anodic coating without magnetism**

- SYIC - 83342 HME 610
- SYIC - 83344 HME 420
- SYIC - 83346 HME 1020

- Accuracy of the point to point is within 0.002mm.
- R.P.M. within 400-600.
- Max. flange is clear for four sight.
- 4mm is the min. hole that could be tested.
- Suitable for milling machine, drilling machine, boring machine.

